

DETAIL

NOTES:

1. Each roundabout traffic arrow pavement marking shall be centered in the travel lane.
2. The grid lines are 4 in. apart.

ROUNDABOUT TRAFFIC ARROWS WITH QUANTITIES

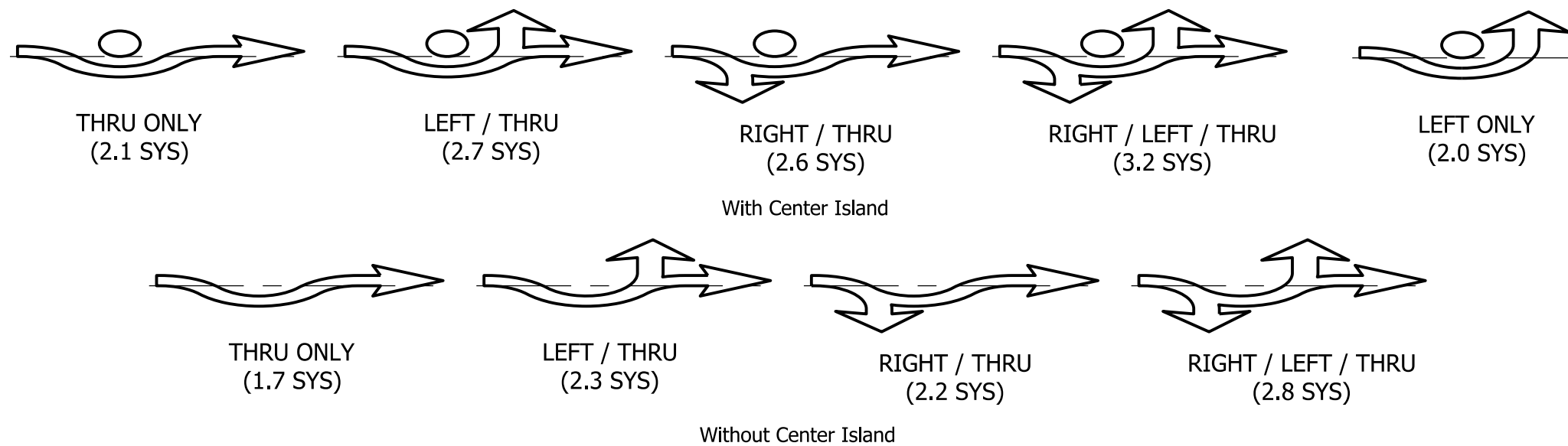

INDIANA DEPARTMENT OF TRANSPORTATION									
PAVEMENT MARKINGS ROUNDABOUT TRAFFIC ARROWS									
SEPTEMBER 2015									
STANDARD DRAWING NO.	E 808-MKPM-01								
	<table style="width: 100%; border-collapse: collapse;"> <tr> <td style="width: 80%; border-bottom: 1px solid black;">/s/ <i>David H. Boruff</i></td> <td style="width: 20%; border-bottom: 1px solid black;">03/04/15</td> </tr> <tr> <td style="font-size: small;">DESIGN STANDARDS ENGINEER</td> <td style="font-size: small;">DATE</td> </tr> <tr> <td style="border-bottom: 1px solid black;">/s/ <i>Mark A. Miller</i></td> <td style="border-bottom: 1px solid black;">03/06/15</td> </tr> <tr> <td style="font-size: small;">CHIEF ENGINEER</td> <td style="font-size: small;">DATE</td> </tr> </table>	/s/ <i>David H. Boruff</i>	03/04/15	DESIGN STANDARDS ENGINEER	DATE	/s/ <i>Mark A. Miller</i>	03/06/15	CHIEF ENGINEER	DATE
/s/ <i>David H. Boruff</i>	03/04/15								
DESIGN STANDARDS ENGINEER	DATE								
/s/ <i>Mark A. Miller</i>	03/06/15								
CHIEF ENGINEER	DATE								

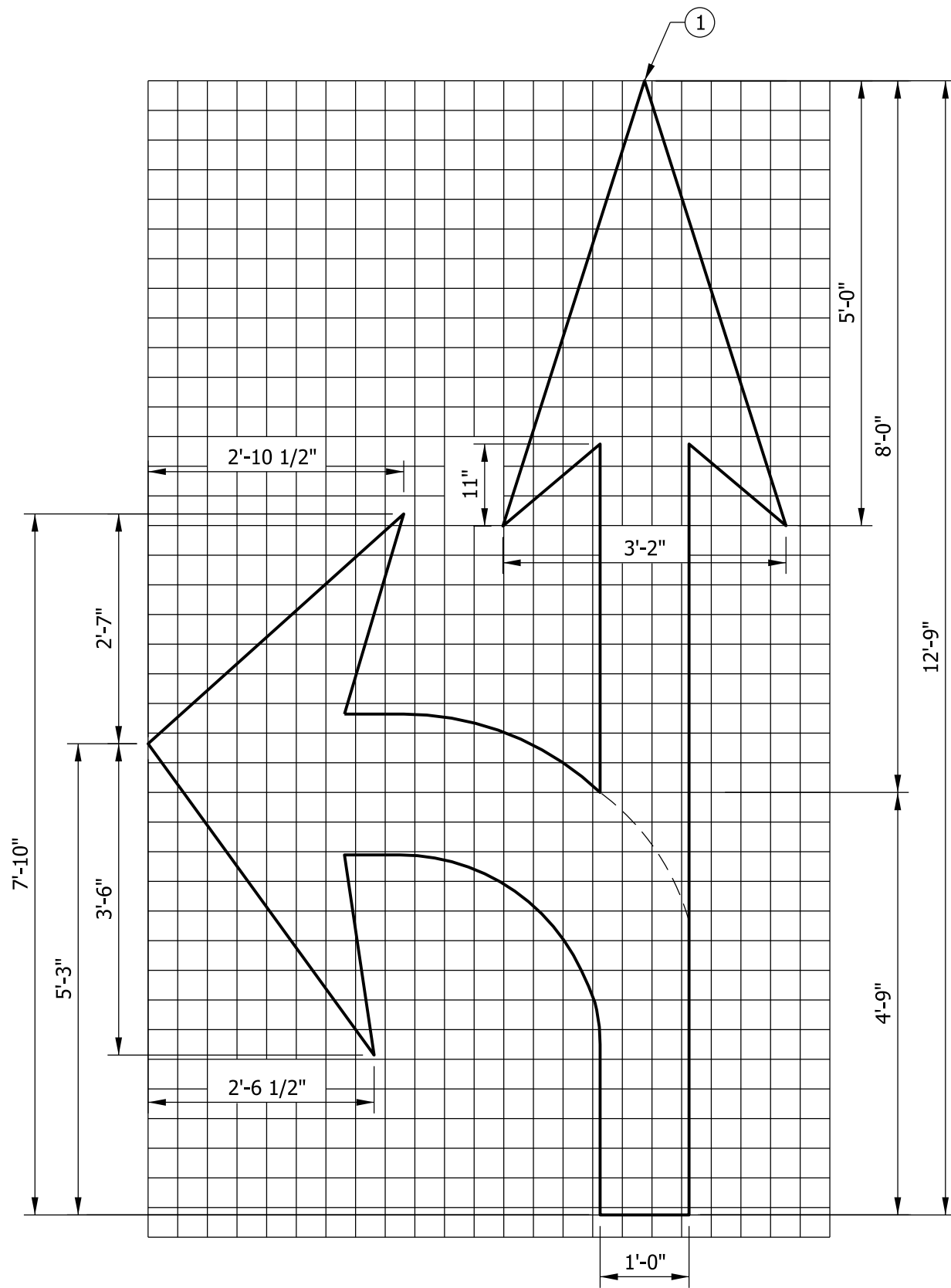

LEFT/THRU ARROW ③

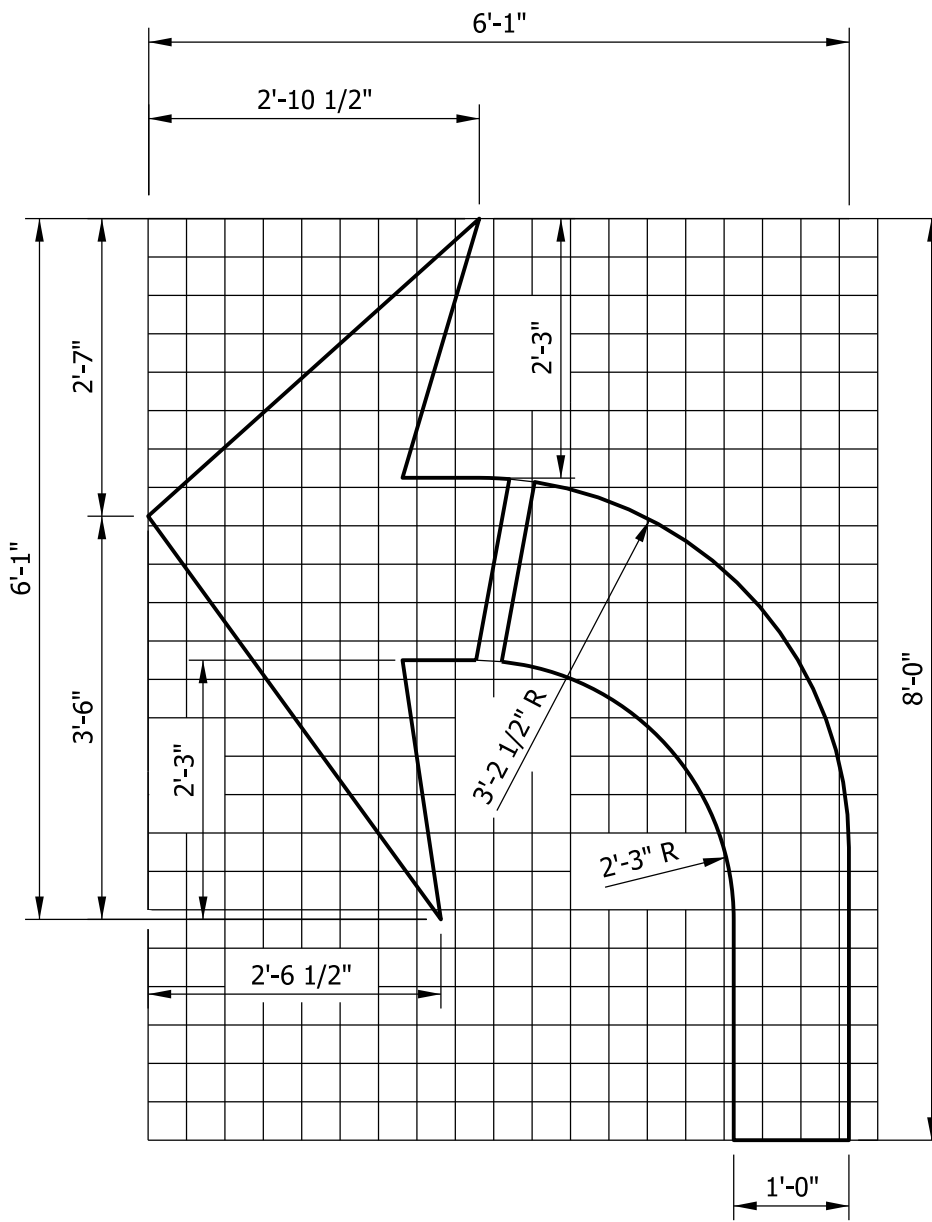

LEFT ONLY ARROW ③

NOTES:

- ① The tip of the lane indication arrow closest to the stop line shall be 20 ft in advance of the nearest edge of the stop line.
- 2. The grid lines are 4 in. apart.
- ③ Reverse the dimensions of the left arrow for a right/thru or right only arrow.

INDIANA DEPARTMENT OF TRANSPORTATION
 TRANSVERSE MARKINGS
 TURN ARROWS
 SEPTEMBER 2015
 STANDARD DRAWING NO. E 808-MKPM-02

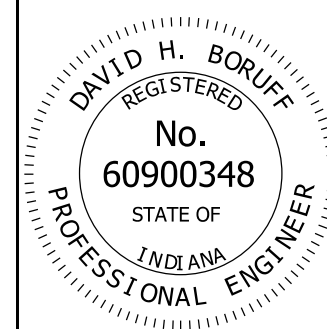

/s/ David H. Boruff	03/04/15
DESIGN STANDARDS ENGINEER	DATE
/s/ Mark A. Miller	03/06/15
CHIEF ENGINEER	DATE

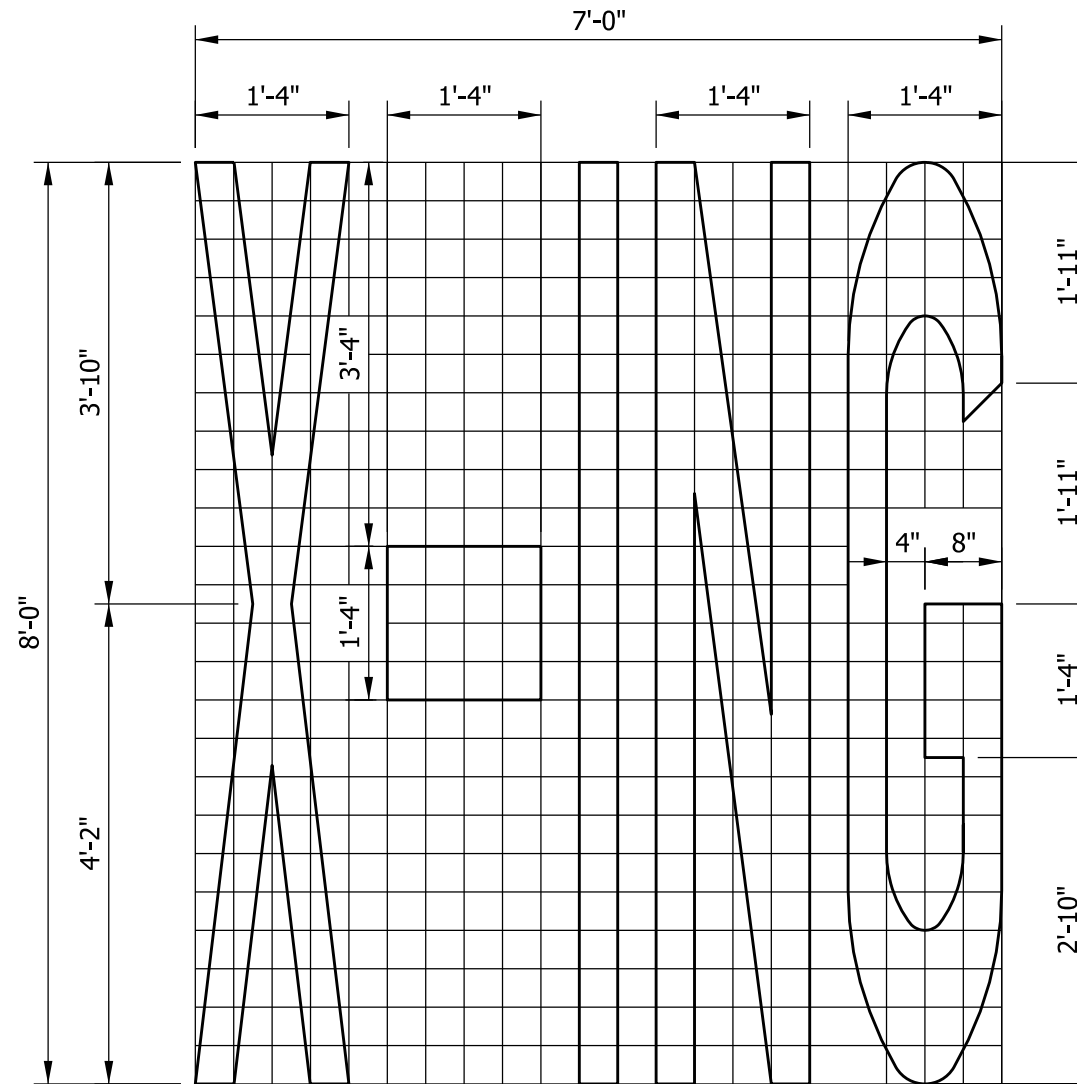
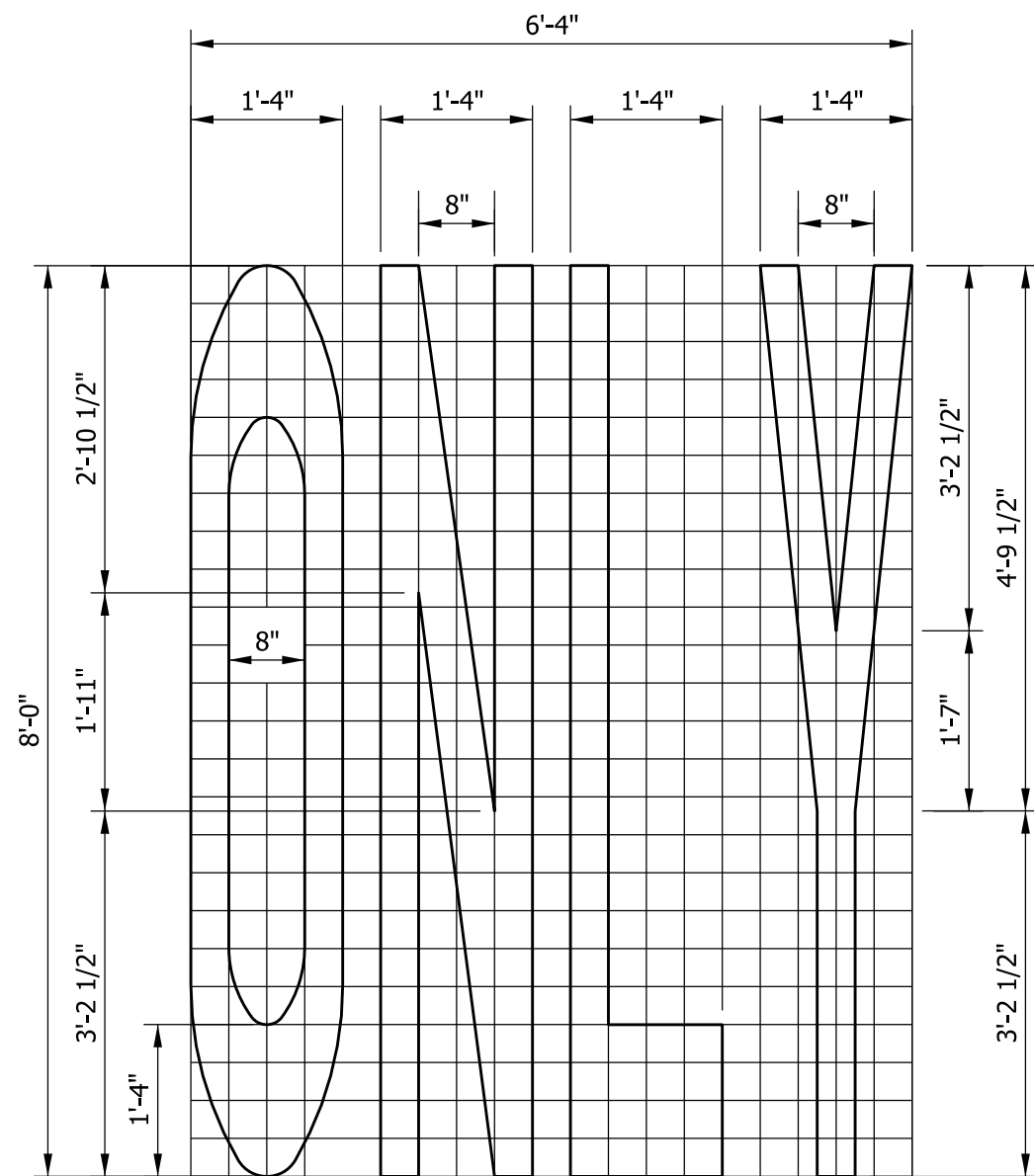

NOTES:

1. The top part of the word ONLY shall be placed prior to the lane indication arrow, 32 ft for posted speeds \leq 45 mph but not more than 80 ft for posted speeds $>$ 45 mph.
2. Each letter is 1'-4" wide. Vertical line segments within each letter are 4" wide. Spaces between vertical line segments are 4".
3. The grid lines are 4 in. apart.

INDIANA DEPARTMENT OF TRANSPORTATION

TRANSVERSE MARKINGS
WORD MESSAGES
"ONLY" AND "X-ING"
SEPTEMBER 2015

STANDARD DRAWING NO. E 808-MKPM-03

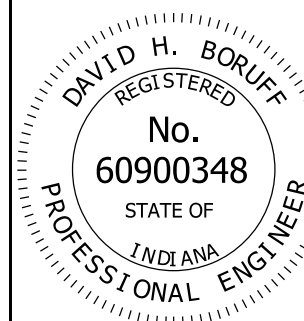

<i>/s/ David H. Boruff</i>	03/04/15
DESIGN STANDARDS ENGINEER	DATE
<i>/s/ Mark A. Miller</i>	03/06/15
CHIEF ENGINEER	DATE

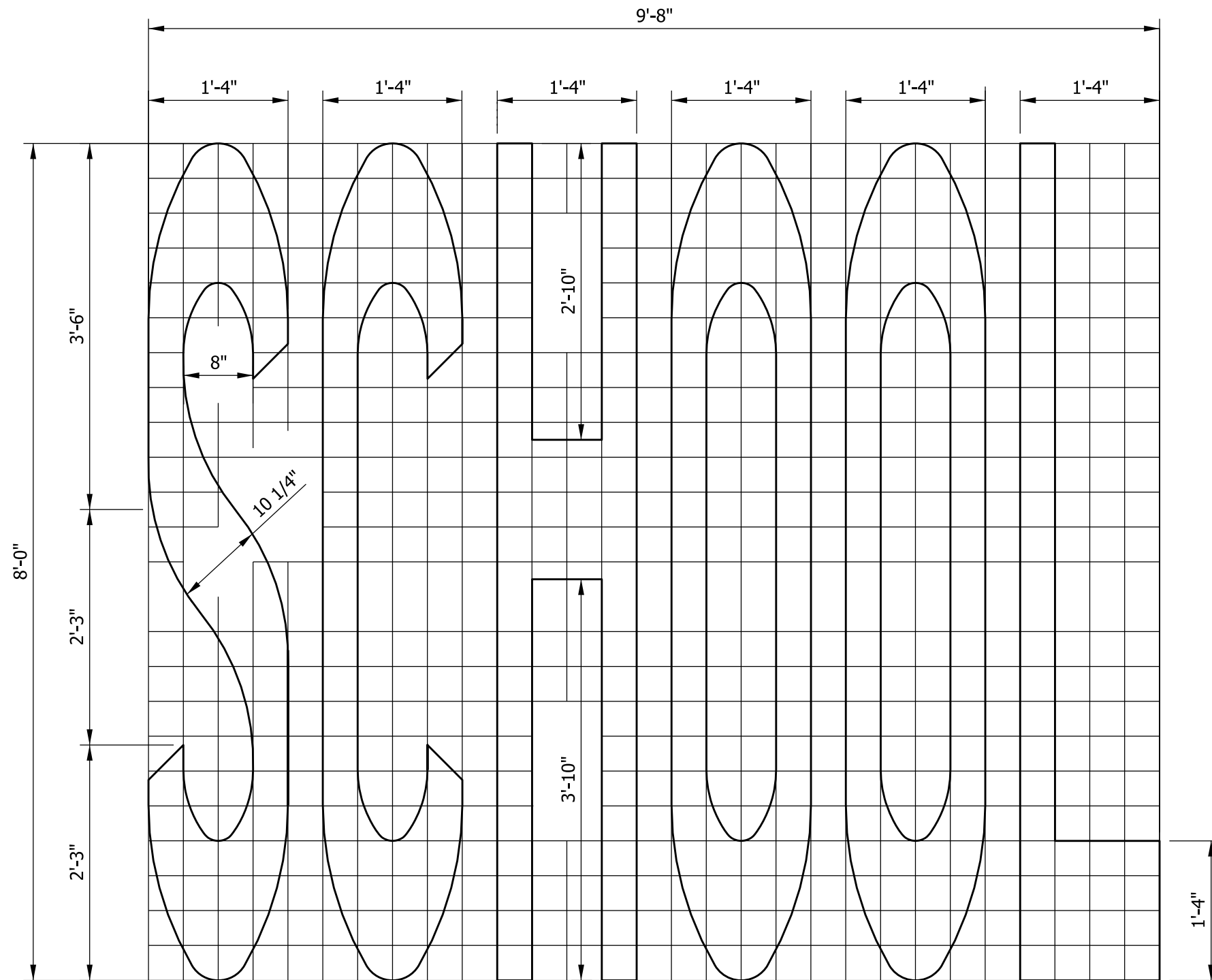

NOTES:

1. Each letter is 1'-4" wide. Vertical line segments within each letter are 4" wide. Spaces between vertical lines are 4".
2. Grid lines are 4 in. apart.

INDIANA DEPARTMENT OF TRANSPORTATION	
TRANSVERSE MARKINGS WORD MESSAGE "SCHOOL" SEPTEMBER 2015	
STANDARD DRAWING NO.	E 808-MKPM-04
	<i>/s/ David H. Boruff</i> 03/04/15 DESIGN STANDARDS ENGINEER DATE
	<i>/s/ Mark A. Miller</i> 03/06/15 CHIEF ENGINEER DATE

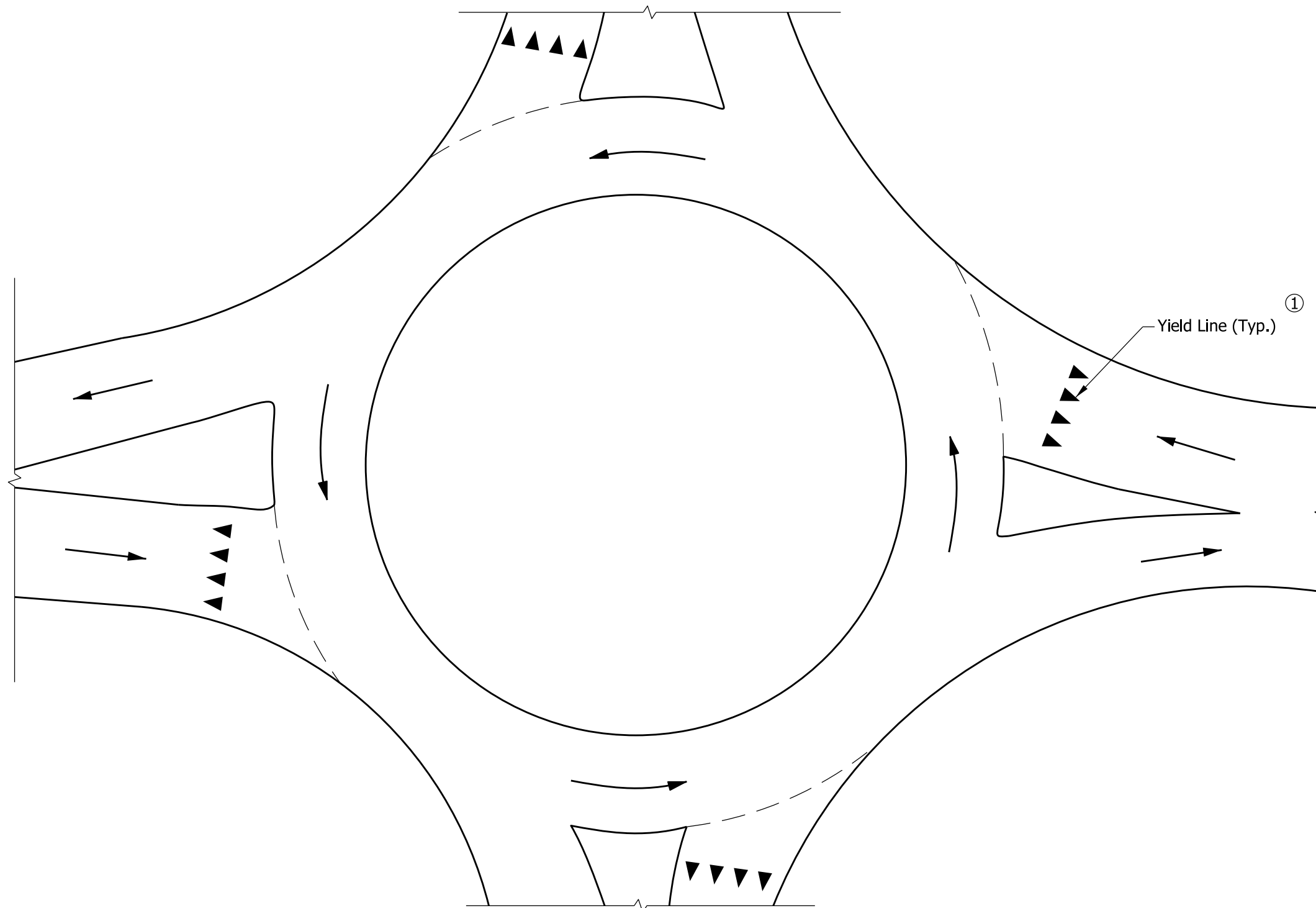

YIELD LINE PLACEMENT

NOTES:

- ① Yield line width and placement shall be as shown on the plans.

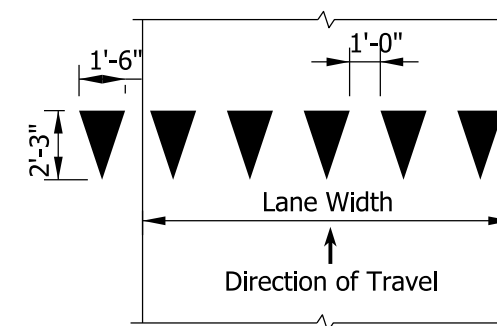

27 INCH WIDE YIELD LINES

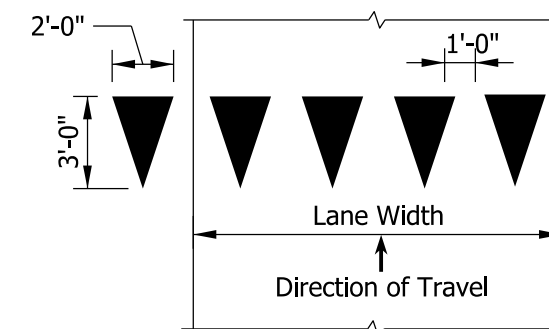

36 INCH WIDE YIELD LINES

INDIANA DEPARTMENT OF TRANSPORTATION	
TRANSVERSE MARKINGS YIELD LINES	
SEPTEMBER 2015	
STANDARD DRAWING NO.	E 808-MKPM-05
	<i>/s/ David H. Boruff</i> 03/04/15 DESIGN STANDARDS ENGINEER DATE
	<i>/s/ Mark A. Miller</i> 03/06/15 CHIEF ENGINEER DATE

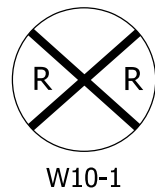
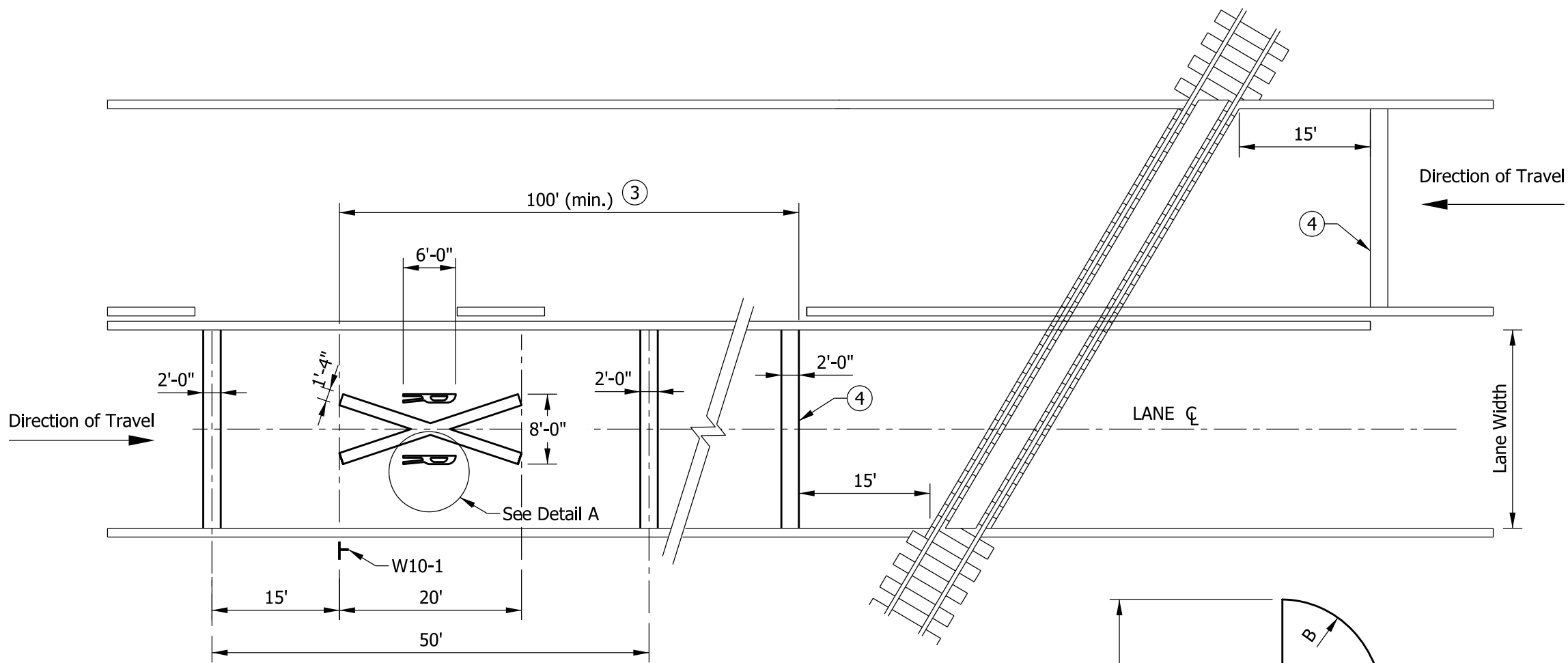

ADVANCE PLACEMENT DISTANCE (3)	
DESIGN SPEED (MPH)	DISTANCE (FT)
30	100
35	100
40	125
45	175
50	250
55	325
60	400

A = 2 3/4"
 B = 11 1/2"
 C = 5 3/4" R

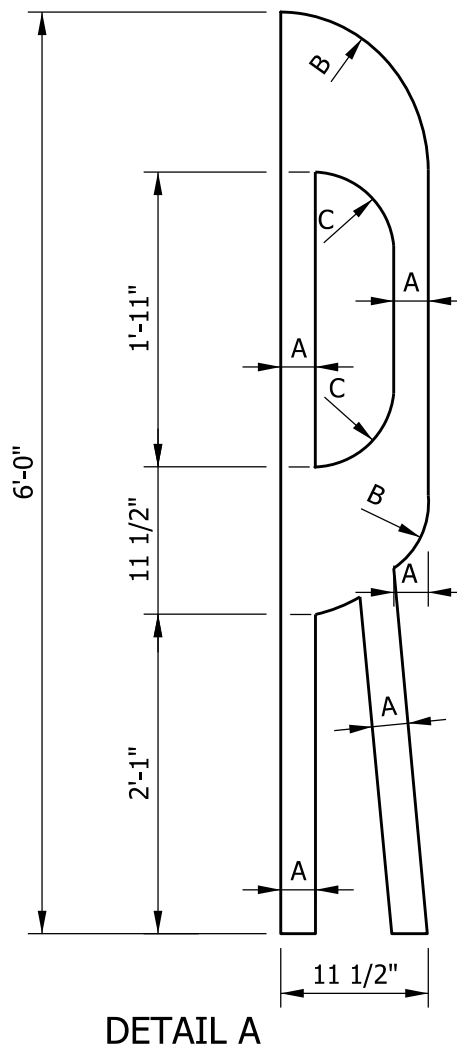

NOTES:

1. For two-way left-turn lanes, the center lane shall be discontinued across the railroad crossing and marked as a flush median or as a one-way left-turn lane.
2. For a multi-lane highway, the transverse lines shall be extended across all approach lanes, and the individual railroad crossing symbols provided in each lane.
- (3) Advance Placement Distance Table is in accordance with the MUTCD.
- (4) Stop line is approximately 8 ft from gate (if present).

INDIANA DEPARTMENT OF TRANSPORTATION	
TRANSVERSE MARKINGS RAILROAD CROSSINGS	
SEPTEMBER 2015	
STANDARD DRAWING NO.	E 808-MKPM-06
	/s/ David H. Boruff 03/04/15 DESIGN STANDARDS ENGINEER DATE
	/s/ Mark A. Miller 03/06/15 CHIEF ENGINEER DATE